



1 Acre on 108 Cherry Street in Azle



1 Acre on 108 Cherry Street in Azle

Model number: 52NXT28684AH18

4 beds • 2 baths • 1904 sq.ft. • 28' width • 68' depth

Our home building facilities invest in continuous product and process improvements. Plans, dimensions, features, materials, specifications and availability are subject to change without notice or obligation. Renderings and floor plans are representative likenesses of our homes and may differ from the actual homes. We invite you to tour a Home Center near you and inspect the highest value in quality housing available or call (817) 237-6706 to speak with a Home Consultant. Copyright 2017, CMH. All rights reserved.

<https://www.claytonhomesfortworth.com>

CLAYTON HOMES-FORT
WORTH

9900 JACKSBORO HIGHWAY
FORT WORTH, TX 76135

Monday - Thursday: 9am - 5:30pm
Friday: 9am - 5:30pm
Saturday: 9am - 5pm
Sunday: Closed

(817) 237-6706



1 Acre on 108 Cherry Street in Azle

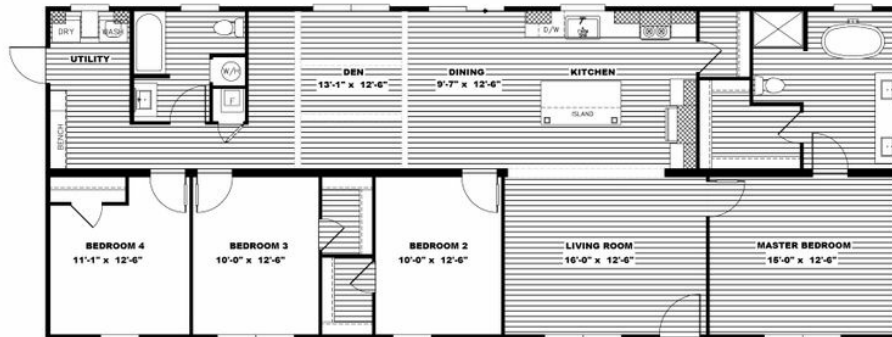

1 Acre on 108 Cherry Street in Azle Model number: 52NXT28684AH18

4 beds • 2 baths • 1904 sq.ft. • 28' width • 68' depth

Our home building facilities invest in continuous product and process improvements. Plans, dimensions, features, materials, specifications and availability are subject to change without notice or obligation. Renderings and floor plans are representative likenesses of our homes and may differ from the actual homes. We invite you to tour a Home Center near you and inspect the highest value in quality housing available or call (817) 237-6706 to speak with a Home Consultant. Copyright 2017, CMH. All rights reserved.

<https://www.claytonhomesfortworth.com>

CLAYTON HOMES-FORT WORTH

**9900 JACKSBORO HIGHWAY
FORT WORTH, TX 76135**

Monday - Thursday: 9am - 5:30pm
Friday: 9am - 5:30pm
Saturday: 9am - 5pm
Sunday: Closed

(817) 237-6706